

Seat Me Safely

# New baby\*

Baby faces back of the car in a rearward facing child seat or a capsule.

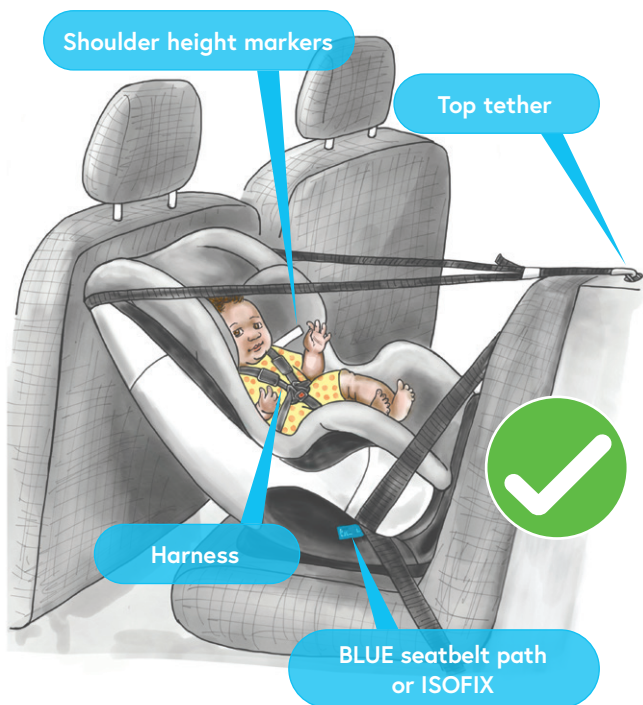

*\*Birth to 12 months*

# Seat Me Safely



## Shoulder height markers

Baby faces back of the car until shoulders reach the top height marker.

## Harness straps

Straps must be on or just above the baby's shoulders.



Straps must be firm



Straps must have no twists



## BLUE seatbelt path

Seatbelt goes through the BLUE path.

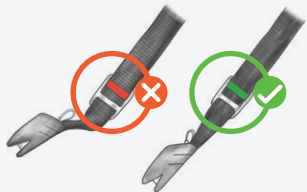

## ISOFIX connector

If using ISOFIX, indicator turns green when tightened.



## Top Tether

Tether attached to the anchor point should be firm with no twist.